

The product using material and processing must conform to the "WI-PZ-001"HSF technical standard control requirements

RoHS+HF

- NOTE:
- MATERIAL SPECIFICATION:
 - HOUSING: LCP,UL94V-0
 - CONTACTS: PHOSPHOR BRONZE
 - PLATING SPECIFICATION:
 - CONTACTS: FLASH GOLD OVERALL NICKEL UNDR PLATED
 - MECHANICAL PERFORMANCE:
 - RETENTIVITY FORCE: 0.3kgf min
 - DURABILITY: 30 CYCLES.
 - ELECTRICAL PERFORMANCE:
 - CURRENT RATING: 0.3A
RATED VOLTAGE : 50V AC/DC
 - CONTACT RESISTANCE: 50 mΩ MAX
 - INSULATION RESISTANCE: 500MΩ Min
 - DIELECTRIC WITHSTANDING : 150V
 - ENVIRONMENTAL PERFORMANCE:
 - OPERATING TEMPERATURE: -40°C~+85°C.
 - PACKAGE SPEC: REEL
 - P/N: B0503 21 F 0-2 XX 2 X X 1 01

- SERIES NO: [] NO SOLDER TABS
- HEIGHT: [] 21-2.10H
- MALE FEMALE: []
- ANGLE: [] 0-180°
- ROW NO: [] 2-DOUBLE ROW
- PIN Q'PY: [] 10~80pin
- COLOR: A-BLACK, K-WHITE, S-NATURE
- PLATING: A-ALL AU G/F, C-BRIGHE TIN, D-MATTE Tin
- TERMIPOINT: 2-SMT

	A	B	C	D
10 PIN	4.70	2.00	3.20	4.10
12 PIN	5.20	2.50	3.70	4.60
14 PIN	5.70	3.00	4.20	5.10
20 PIN	7.20	4.50	5.70	6.60
22 PIN	7.70	5.00	6.20	7.10
24 PIN	8.20	5.50	6.70	7.60
30 PIN	9.70	7.00	8.20	9.10
32 PIN	10.20	7.50	8.70	9.60
36 PIN	11.20	8.50	9.70	10.60
40 PIN	12.20	9.50	10.70	11.60
50 PIN	14.70	12.00	13.20	14.10
60 PIN	17.20	14.50	15.70	16.60
70 PIN	19.70	17.00	18.20	19.10
80 PIN	22.20	19.50	20.70	21.60

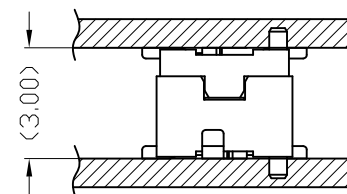
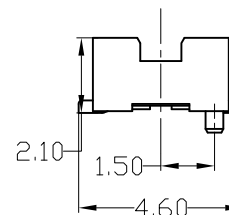
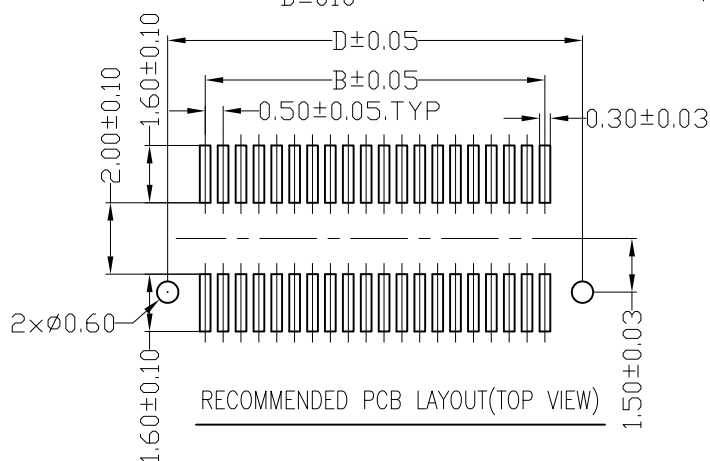
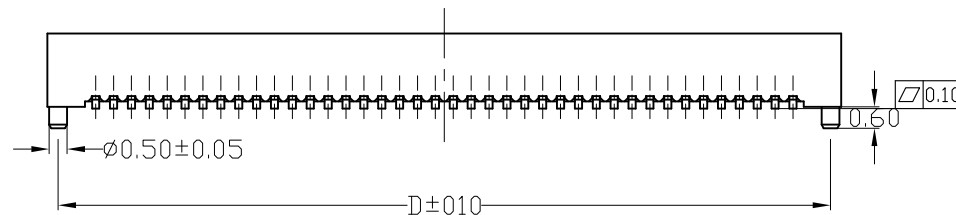
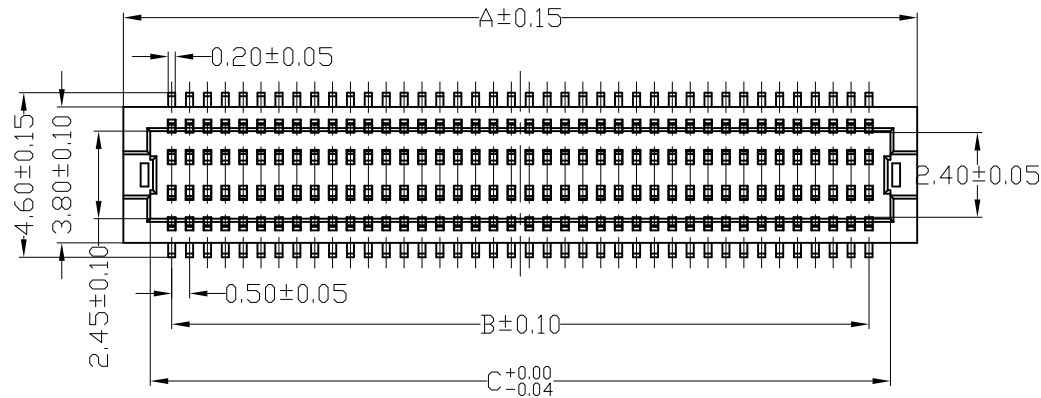

REV.	REVISION RECORD	DATE	GENERAL TOLERANCES		SCALE:	NAME	DATE	PART.NO:	DWG.NO:	 WanLian Teconology Co., Ltd
AO	NEW RELEASE	21.10.12	LINEAR	ANGLES	1:1	Wang_jr	21.10.12	B050321F0-2XX2XX101	ENDE05	
			0.0±0.35	X'REF±6°	APPROVED	Han_Gao	21.10.12	TITLE:		
			0.00±0.25	X'±3°	DESIGNER	Zijun_Huang	21.10.12	Board to Board Pitch0.5mm DF12 H2.1mm		
			SIZE: A4	0.000±0.10	DRAWN			双排立贴带柱母座		REV: A0 SHEET: 1/2

The product using material and processing must conform to the "WI-PZ-001"HSF technical standard control requirements

RoHS+HF

NOTE:

- 1.10 Sprocket hole pitch cumulative tolerance ± 0.20 .
2. Carrier camber is within 1mm in 100mm.
3. Material: black conductive polystyrene alloy.
4. Material Thickness: 0.3 ± 0.05 mm.
5. All dimensions meet EIA-481-B requirements.
6. 1000pcs Pef Reel.
7. For tape width(dim W)16 and 24mm pilot holes are provided on one sides.
For tape width(dim W)32, 44 and 56mm pilot holes are provided on both sides.

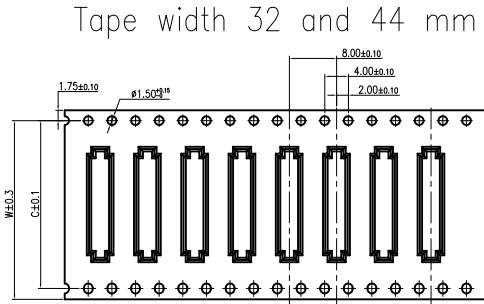
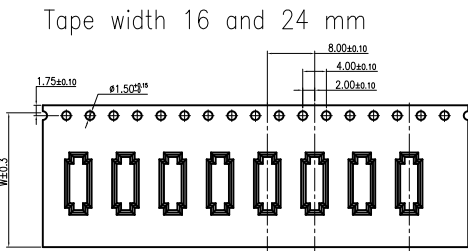

PULL OUT DIRECTION

PULL OUT DIRECTION

COVER TAPE
(上盖带)

PULL OUT DIRECTION

165°~180°
(PEELING ANGLE)

CARRIER TAPE
(下载带)

REEL
(胶盘)

GP LABEL
(环保标签)
(1PCS)

LABLE
(标签)

SAFE TAPE
(安全带L=1750mm Ref)

SCALE 1:4

W+4

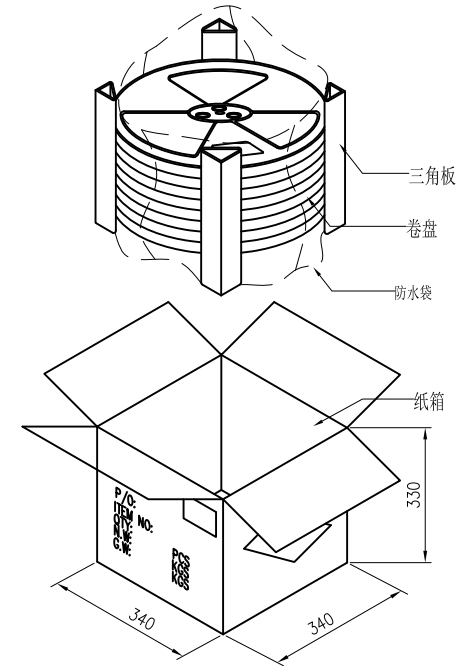

PIN NO.	W	C	PCS /REEL	REEL/CARTON	SUM(PCS)
10PIN~20PIN	16	-	2500	15	37500
30PIN~50PIN	24	-	2500	10	25000
60Pin~80PIN	32	28.4	2500	8	20000

REV.	REVISION RECORD	DATE	GENERAL TOLERANCES		SCALE:	NAME	DATE	PART.NO: B050321M0-2XX2XX101 B050321F0-2XX2XX101	DWG.NO: ENDE05	 WanLian Teconology Co., Ltd
AO	NEW RELEASE	21.10.12	LINEAR	ANGLES	1:1	Wang_jr	21.10.12			
			0.0±0.35	X'REF±6°		Han_Gao	21.10.12	TITLE: H3.0公母座共用包装图	REV: A0	SHEET: 2/2
			UNIT:mm	X'±3°		Zijun_Huang	21.10.12			
			SIZE: A4	0.000±0.10						